

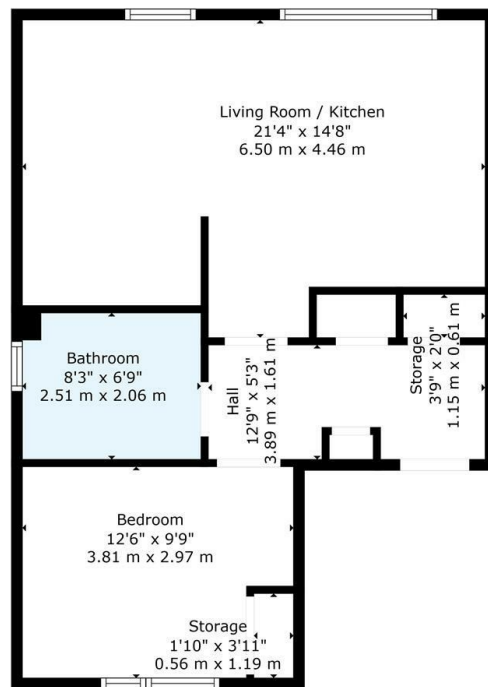

4/1, 38 Oban Drive, Glasgow, G20 6LR

Offers Over £165,000

- Modern 4th floor apartment
- Elevator
- Open plan kitchen/diner/living room
- Stylish presentation
- Allocated residents parking
- EER- B
- Lovely Aspects
- Excellent North Kelvinside location



TOTAL: 536 sq. ft, 50 m²
 FLOOR 1: 536 sq. ft, 50 m²
 EXCLUDED AREAS: STORAGE: 15 sq. ft, 2 m², UNDEFINED: 7 sq. ft, 1 m²
 WALLS: 52 sq. ft, 4 m²
 Floor Plan Created By Cubicase App. Measurements Deemed Highly Reliable But Not Guaranteed.

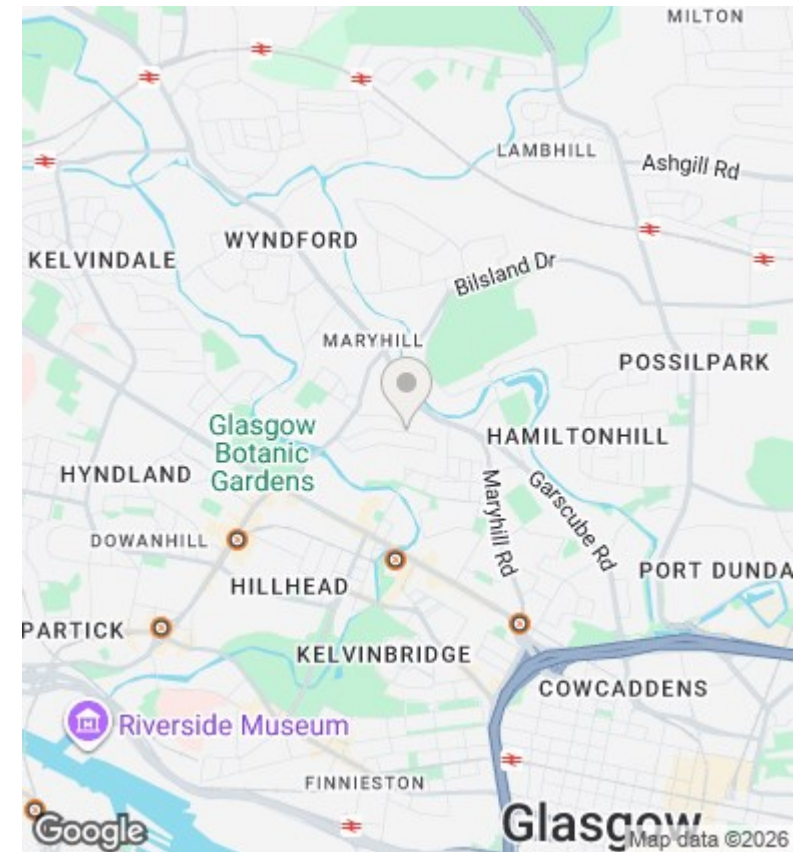

Directions

Viewings

Viewings by arrangement only. Call 01417262111 to make an appointment.

Council Tax Band

C

EPC Rating:

B

Energy Efficiency Rating		
	Current	Potential
Very energy efficient - lower running costs		
(92-plus) A		
(81-91) B	81	81
(69-80) C		
(55-68) D		
(39-54) E		
(21-38) F		
(1-20) G		
Not energy efficient - higher running costs		
Scotland	EU Directive 2002/91/EC	